

Picture hanging

PICTURE HANGING
SYSTEMS

2200-2300/01



G-RAIL®
ALUMINIUM RAIL

> *by Goelst*



Especially suitable for galleries, educational and care establishments, as well as commercial and domestic applications - pictures can be changed or moved many times without unnecessary wall damage. Profile 2200 can be installed as a continuous feature line whilst 2300 and 2301 can be discreetly hidden from view.

Colours 2200: White RAL 9010, natural, brown, gold. Special colours on request.

Colours 2300: White RAL 9010, natural, black

Colours 2301: White RAL 9010, natural.

2200, 2300, 2301

quick and picture

PICTURE HANGING SYSTEMS

2200-2300/01



Installation

2200
wall mounting with 2254

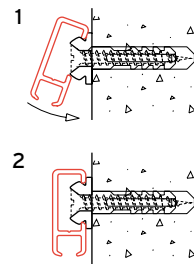

2300
ceiling mounting

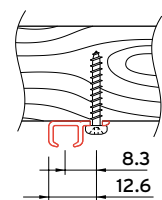

2301
wall mounting

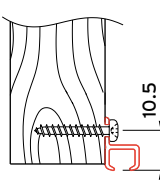

shadow batten

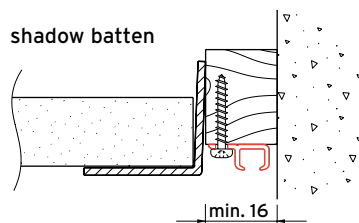

2075

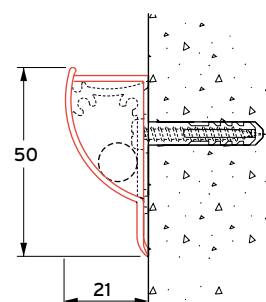
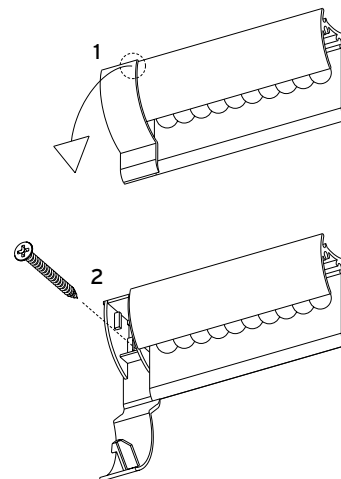

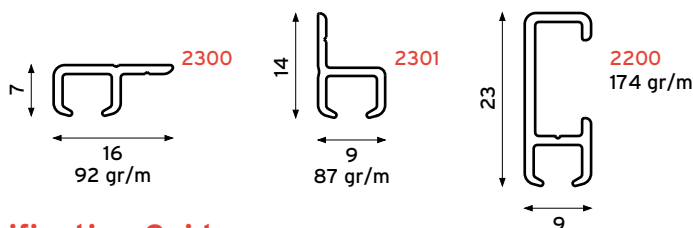
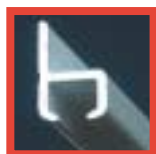

Specification Guide

Material:

Aluminium 606035-T6-F22. (Higher specification than DIN 1725).
Shape and size tolerances are in accordance with DIN 17615.
Satin silver anodised or powder coated in accordance with the Qualicoat standard. Special colours are available on request.
Rail weight 2200: 174 gr/m. Rail weight 2300: 92 gr/m.
Rail weight 2301: 87 gr/m.

Accessories

Perlon cord 2070-00 with track insert or Perlon cord 2070-65 with speed hook. Standard length 150 cm or 250 cm, ø2 mm. Extended lengths are available on request.
Perlon cord maximum load: 20 kg.
2200: End caps 2253, Corner connector 2248.
2300 and 2301: pozi-drive screw 2314.

Picture hanging sets: max. load (hook):

| | | | |
|---------|-----|----|----------------------------|
| 2070-10 | 2,5 | kg | |
| 2070-20 | 5 | kg | |
| 2070-30 | 7 | kg | |
| 2070-40 | 10 | kg | |
| 2070-50 | 10 | kg | per rod and 6 kg per hook. |
| 2070-81 | 15 | kg | |

Memo holder 2070-90.

Installation:

2200 : Wall fixing with wall clip 2254.
2300 : Top fixing to timber with pozi-drive screw 2314.
2301 : Face fixing to timber with pozi-drive screw 2314.
Standard fixing hole centres 2300 and 2301: 15 cm.
Fixing in accordance with the load table.

Load table

| bracket distance (cm) | | weight (kg) | | | | |
|-----------------------|----|-------------|------|-----|------|-----|
| | | 2,5 | 5 | 10 | 15 | 20* |
| 2200 | 40 | 0,15 | 0,3 | 0,6 | 1 | 1,4 |
| | 50 | 0,3 | 0,6 | 1 | 1,5 | |
| | 80 | 0,75 | 1,5 | | | |
| 2300 | 15 | 0,1 | 0,15 | 0,4 | 0,6 | |
| 2301 | 15 | 0,1 | 0,25 | 0,4 | 0,65 | |

Norms: deflection in mm.

From an aesthetic point of view we advise a maximum deflection of 1.5 mm.

* Used only when several hooks are placed on a single perlon cord.

Product example



Memo papers are simply inserted into the opening of the aluminium profile and held in place without the need of drawing pins or magnets. Supplied complete ready assembled in the following sizes: 28, 50, 100, 150 & 200 cm. Memorail is available finished white powder coat and satin silver anodised. End caps are supplied in grey as standard - white end caps 2075-53 can be ordered separately.

> Ideal for
precise
hanging.

Components

Product design and specification changes reserved.

| PICTURE HANGING | | | ACCESSORIES | | |
|-----------------|---|--|--------------------------------|---|--|
| | 2070-00 perlon cord with insert | | 2070-90 memo holder | | 2248 corner connector for 2200 colours: GR - W |
| | 2070-10 picture hanging set; max 2,5 kg | | 2070-11 picture hook | | 2253 end cap for 2200 colours: B - G - GR - W |
| | 2070-20 picture hanging set; max 5 kg | | 2070-21 picture hook | | 2254 button clip for 2200 |
| | 2070-30 picture hanging set; max 7 kg | | 2070-31 picture hook | | 2070-65 perlon cord with speed hook |
| | 2070-40 picture hanging set; max 10 kg | | 2070-41 picture hook | | 2314 pozi-drive screw for 2300 & 2301 colours: N - W - Z |
| | 2070-80 picture hanging set; max 15 kg | | 2070-81 picture hook | | |
| | 2070-50 picture hanging set; max 6 kg per hook, max 10 kg per rod | | 2070-52 picture hook | | |
| | | | | 2075 memo rail 28, 50, 100, 150 and 200 cm colours: N - W 2075-53 end cap white | |

PICTURE HANGING SYSTEMS

2200-2300/01

B = Brown
G = Gold
N = Natural
W = White
Z = Black
GR = Grey

C-RAIL®

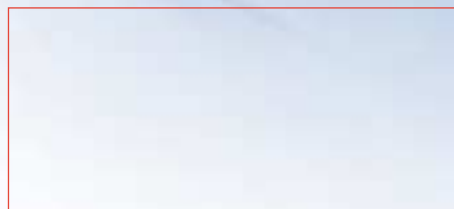
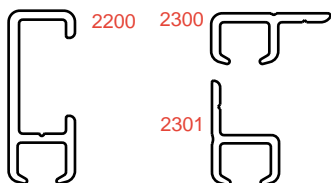

Space for dealer address

02/2002