

**B**olton Gate Company, the acknowledged leader in the field of rolling fire door technology, introduces an enhanced design of fire curtain to provide not only two hour fire integrity between fire compartments but also provides a smoketight seal in accordance with EN 1634-3.

The Fibreroll S Rolling Fire Curtain which has been successfully fire tested to EN 1634-1, offers major advantages over other types of fire curtain since it incorporates reduced radiation in addition to keeping fire and smoke at bay.

The curtain has a fire rating of EW120S<sub>a</sub> in accordance with EN 13501-2.

### STANDARD SPECIFICATION

#### **Curtain**

Specially reinforced and coated fibre-glass material which is designed to withstand temperatures in excess of 1000 degrees C.

The curtain thickness is approximately 0.6mm and the weight 665 grams per square metre.

A steel bottom rail is attached to provide rigidity and act as a weight to assist closure.

#### **Guides**

Manufactured from galvanized steel and formed into a slimline profile 100 x 50mm which is prepared for bolting to the opening structure. An integral sealing arrangement is incorporated to prevent the passage of smoke around the edges of the curtain.

#### **Roller**

The roller comprises a 101mm diameter steel tube in which the tubular motor is fitted at one end and steel shafts / discs at the other. The roller is supported at each end on galvanized steel endplates with integral angles for fixing to the bulkhead.

#### **Casing**

The roller is covered by a galvanized steel casing which also acts as a fire seal at the head and is 230 x 230mm with an integral smoke seal.

### MAXIMUM SIZES

8 metres wide x 6 metres high.



### OPERATION

The curtain is electrically operated by a 240-volt single phase tubular motor and is supplied with a high-level control panel to be connected (wiring by others) to a normally-closed volt-free contact within the building's fire alarm panel.

This system requires a 240-volt single phase three-pin socket within one metre of the control panel; this supply must be installed prior to the installation of the curtains.

The system is failsafe and should the mains supply fail, the curtain closes by gravity.

### FINISHES

The curtain is self-finished in grey one side, silver the other side with the side guides and roller casing galvanized as standard. The metalwork is also available in a polyester powder coated finish in a wide range of RAL colours.

### WEIGHT

Approximately 30 kgs per linear metre of width.

### FACE FIXED

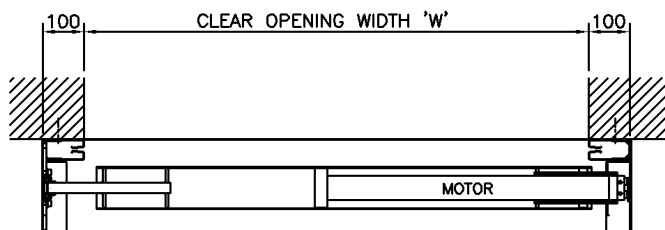

PLAN

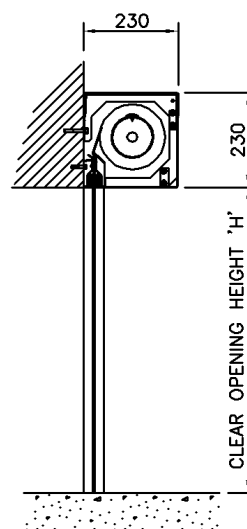

SECTION

### FIXED BETWEEN

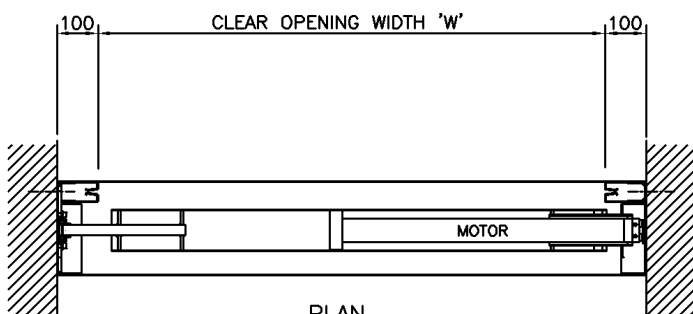

PLAN

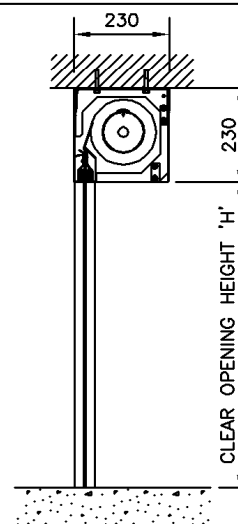

SECTION

### JAMB / GUIDE DETAILS

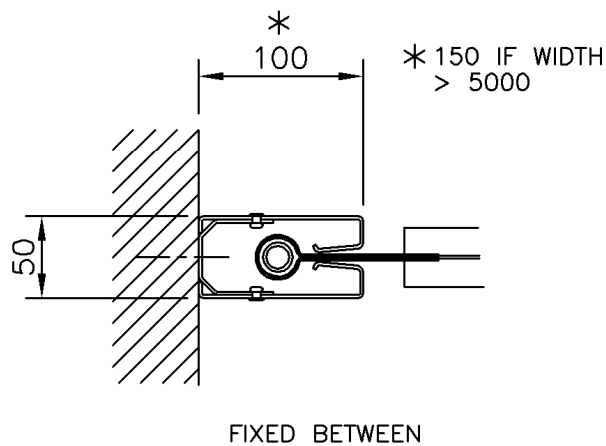
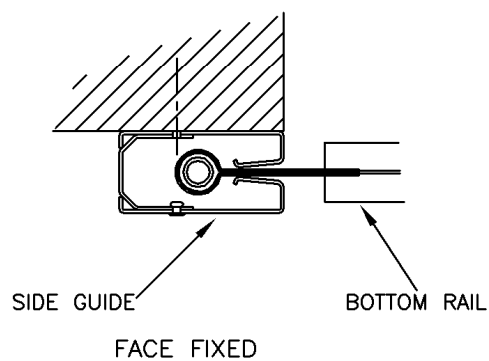

ALL DIMENSIONS IN mm