



# Solus Access & Emergency Escape Hatch

## NBS SPECIFICATIONS

Including emergency escape hatch with overriding manual locking facility externally.

Access Hatches are manufactured with an insulated aluminium upstand. The Access Hatches are manufactured within our factory therefore, can be supplied in various sizes and designs. They can also be motorised and have various security options.



|                      | 'SOLUS' ACCESS HATCH   | 'SOLUS' MOTORISED ACCESS HATCH  |
|----------------------|--|---|
| <b>TYPE</b>          | Hatches suitable for all types of flat/pitched roofs.  |   |
| <b>FRAME</b>         | Aluminium, aluminium to BS 1474:1987 Alloy 6063-T6.  |   |
| <b>FINISH</b>        | Mill Finish/Polyester Powder Coated.   |   |
| <b>COLOUR</b>        | Polyester powder coated to BS 6496 Interpon D36 range. RAL 9010 white matt or any standard RAL colour.   |   |
| <b>KERB</b>          | <b>FR 1</b><br>Lareine Engineering proprietary aluminium upstand 350mm high. This kerb is painted white internally. The upstand is insulated externally with GRP or aluminium to suit your Roofers requirements. Depth of upstand can be changed to suit your particular requirements. | <b>FR 1</b><br>Lareine Engineering proprietary aluminium upstand 400mm high. This kerb is painted white internally. The upstand is insulated externally with aluminium with hidden motors.  |
|                      | <b>BU 1</b><br>Lareine Engineering proprietary aluminium upstand 150mm high. This kerb is painted white internally. The upstand is insulated externally with insulation encapsulated in aluminium. The flange width can be modified to meet your needs.                                | <b>BU 1</b><br>Lareine Engineering proprietary aluminium upstand 150mm high. This kerb is painted white internally. The upstand is insulated externally with insulation encapsulated in aluminium. The flange width can be modified to meet your needs. |
| <b>LID</b>           | <b>TYPE A</b><br>Insulated aluminium lid.  |   |
|                      | <b>TYPE B</b><br>Clear or opal non fragile UV protected polycarbonate dome.  |   |
|                      | <b>TYPE C</b><br>Glass, double-glazed units.   |   |
| <b>'U' VALUE</b>     | Double skin 2.7 W/m²K Triple skin 1.5 W/m²K  |   |
| <b>FRAGILITY</b>     | <b>They have been tested and are classed as NON-FRAGILE Class B to ACR(M)001:2005 Test for Fragility of Roofing Assemblies.</b>  |   |
| <b>FIRE RATING</b>   | BS 476 Part 3. Fire Rating AA. Spread of flames to BS 476 Part 7: Class 1. Class O Material to Building Regulations 1985, Tp (a) Rigid Classification as described in Approved Document B of Building Regulations.   |   |
| <b>ROOF OPENING:</b> | To suit your requirements.   |   |
| <b>OPERATION</b>     | Gas springs.   | 2 no . 24 Volt linear actuators.  |
| <b>OPTION</b>        | Keyed lock to inside standard. Other options available upon request.   | Small control panel with reversing switch including 240v/24v transformer.   |
| <b>FIXING</b>        | In accordance with Lareine Engineering fixing recommendations.   |   |
| <b>SIZES</b>         | Sizes start from 600mm x 600mm. Any size or configuration.   |   |



### LAREINE ENGINEERING LTD

Unit 1, Armadale Industrial Estate,  
Armadale, West Lothian,  
Scotland, EH48 2ND

Tel: 01501 731600/731699

Fax: 01501 733828

E-mail: [info@lareineengineering.com](mailto:info@lareineengineering.com)

Web: [www.lareineengineering.com](http://www.lareineengineering.com)



All Rooflights have been tested at BRE and are manufactured to: BS EN 6375-1:2009 Weather Tightness; BS EN 1026 / 12207:2000 Air Permeability; BS EN 1873 / 12208:2000 Water Tightness; BS EN 12210:2000 Wind Resistance; BS EN 1991-1 Snow Load; BS EN ISO 140 Acoustic; BS EN 1627-1630 Security.



# Solus Access & Emergency Escape Hatch

## FIXING DETAILS

The following diagrams show typical Access Hatch fixing details. Other details upon request.

Internal sizes along with kerbs and upstands can be made to suit individual requirements.

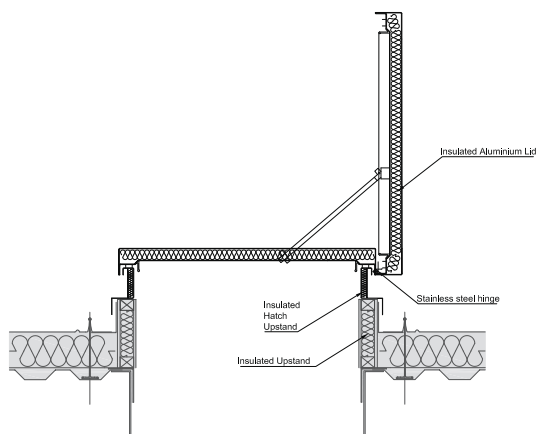
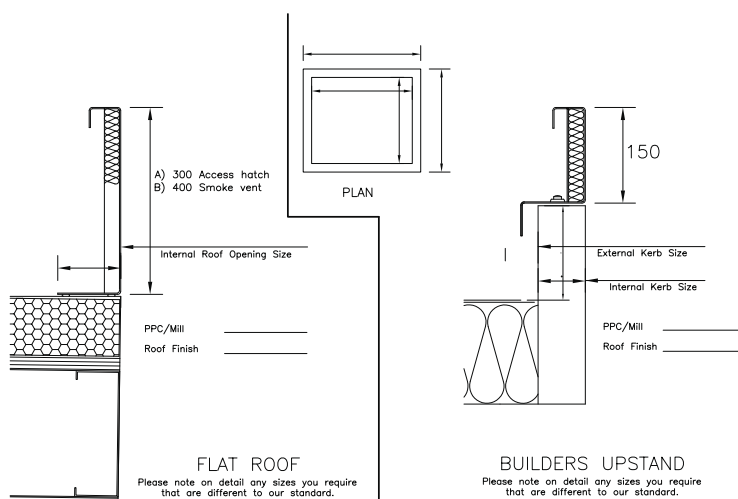

General Notes:  
1. Do not scale this drawing.

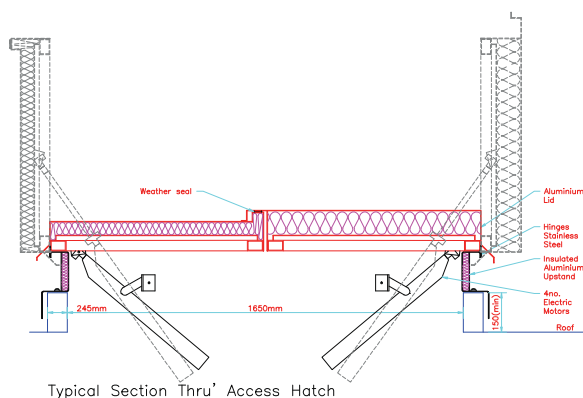

Typical Section Thru' Access Hatch