

(EN) Low velocity duo-header

(DE) Hydraulische Duo-Weiche

(NL) Drukloze duo-verdeler

(FR) Double tuyeau collecteur faible vitesse

(IT) Testata doppia a bassa velocità

(ES)

(CS)

(SL)

(DA)

(EL)

(TR)

(RU)

(HU)

(PL)

(RO)



Üî €€ÀòXU

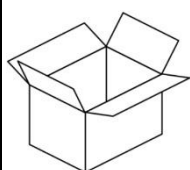

Üî €€ÀòXU

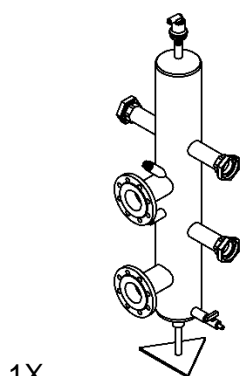

1X

4X

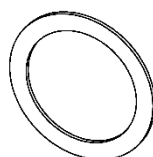

4X

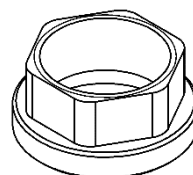

Üî €€ÀòXU

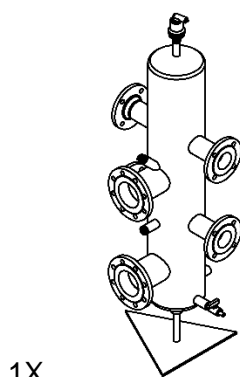

1X

4X

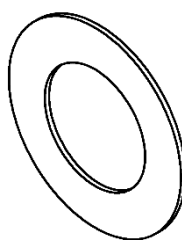

16X



32X

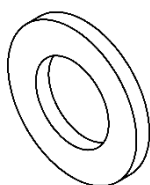

16X

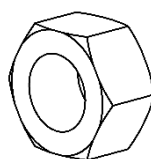

(EN) Low velocity duo-header

(DE) Hydraulische Duo-Weiche

(NL) Drukloze duo-verdeler

(FR) Double tuyeau collecteur faible vitesse

(IT) Testata doppia a bassa velocità

(ES)

(CS)

(SL)

(DA)

(EL)

(TR)

(RU)

(HU)

(PL)

(RO)

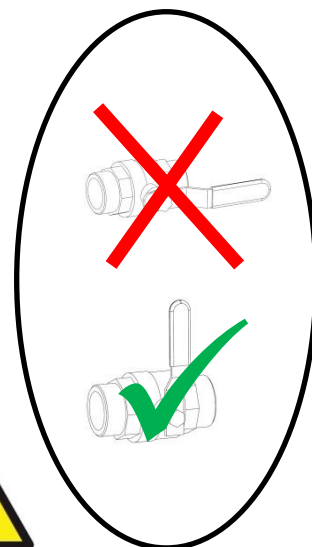
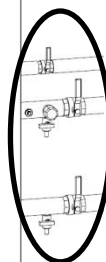
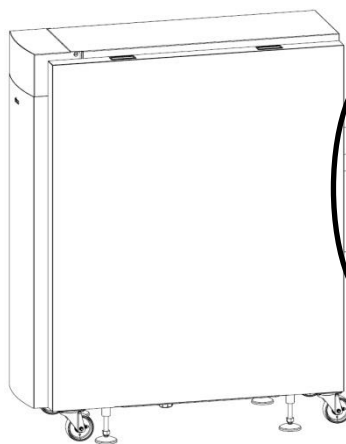
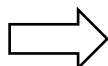

(EN) Low velocity duo-header

(DE) Hydraulische Duo-Weiche

(NL) Drukloze duo-verdeler

(FR) Double tuyeau collecteur faible vitesse

(IT) Testata doppia a bassa velocità

(ES)

(CS)

(SL)

(DA)

(EL)

(TR)

(RU)

(HU)

(PL)

(RO)



R601, R602, R603 EVO

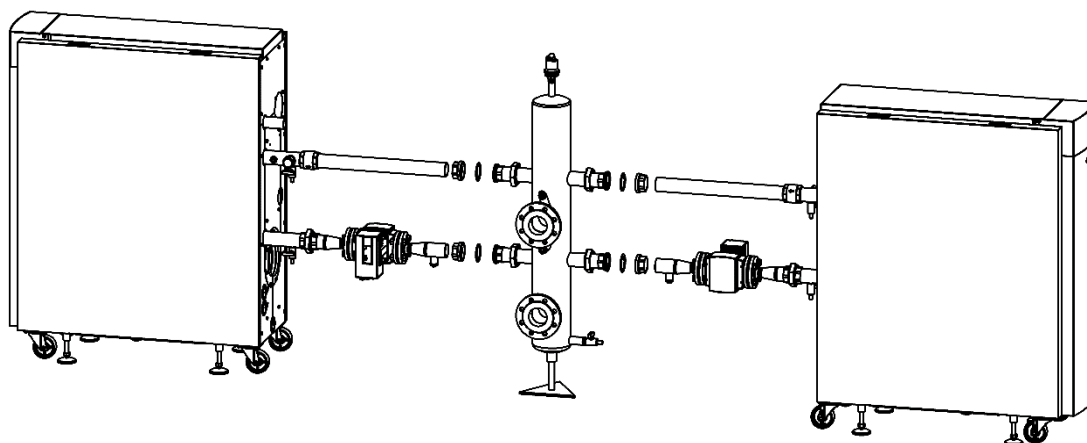

R604, R605, R605, R606, R607 EVO

