

DIGITAL SHOWERS

TECHNOLOGY FOR YOUR BATHROOM



crosswater[™] 

YOUR SHOWER PERFECTED

Wonderfully clever and yet beautifully simple, the Crosswater digital shower gives you complete control over your bathroom.

No hot or cold surges, no wondering whether the shower's warm enough. Simply turn it on with the touch of a button, precisely adjust the flow and temperature, and when the softly lit LEDs stop flashing and glow white, step in – the water's perfect.

There are three control options available: single shower, dual shower, and dual shower and bath flow, and for extra convenience you can even install an additional remote control. So whatever your shower style, you can bring sophisticated, affordable technology to your bathroom.

Learn about what makes digital showering different over the following few pages, and find the key features and technical details on pages 10 to 15. For help choosing the right shower for you, turn to page 17.

Discover the latest bathroom innovation from Crosswater, and start your day with just a single touch.

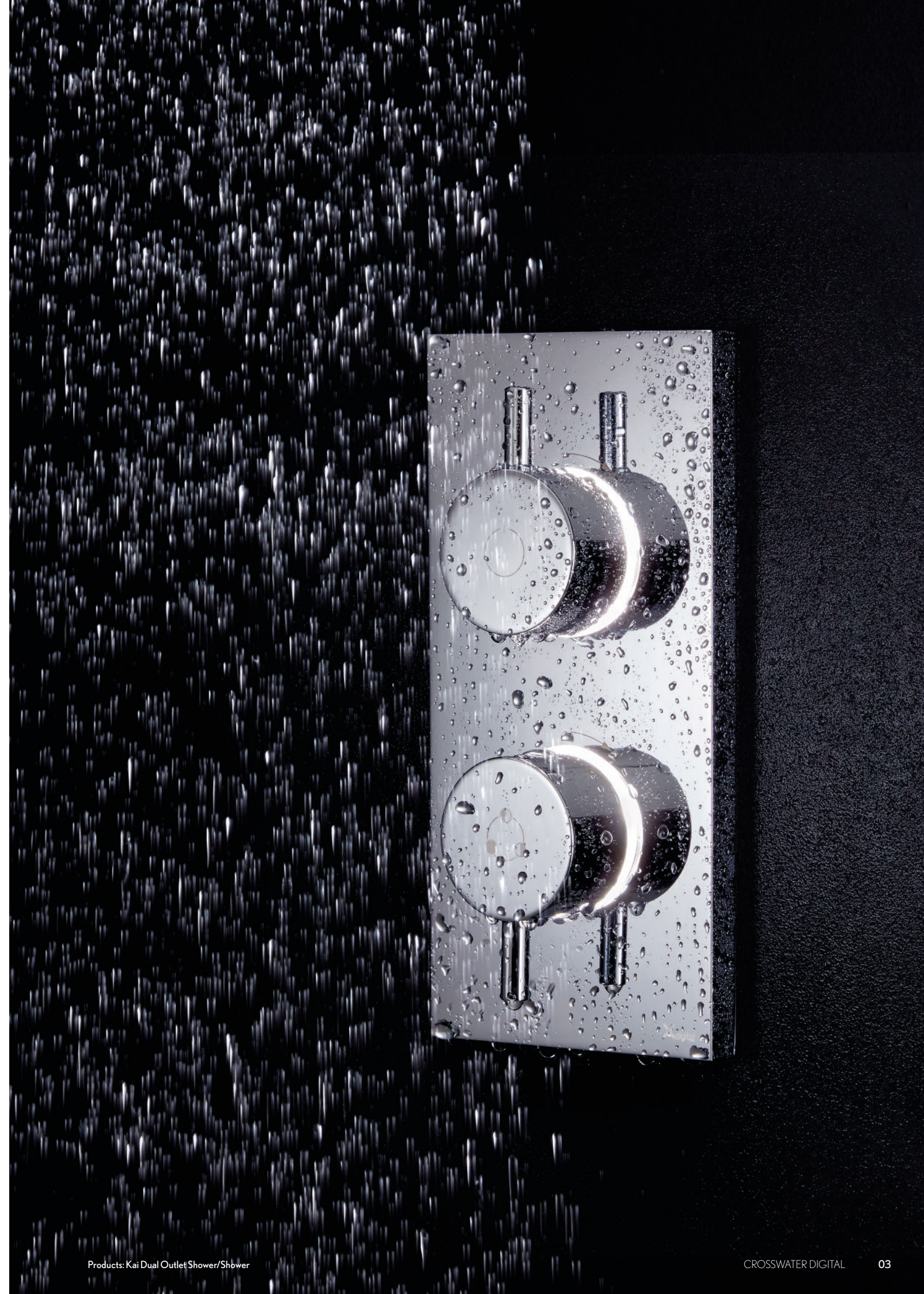

STAND OUT BY BLENDING IN

The clean, subtle design of our digital showers allows them to blend seamlessly into every style of bathroom - and that's what makes them unique.

Our digital showers are fashioned in metal and chrome with touches of ceramic, ensuring a perfectly premium, yet affordable, finish. Choose from three different trim styles combined with one of our numerous shower kits to create your ideal look.





SAFETY FIRST AND ALWAYS

No need to worry about fluctuating temperatures or surges of hot or cold water. Our digital shower closely monitors the temperature to ensure it stays exactly as set – even if someone is using water elsewhere in the house.

If you adjust the temperature, the unique colour-changing controls will flash red as the water heats up, then blue while it's cooling down. Once it reaches your desired temperature the controls glow white to let you know it's ready. And if there's a problem with your water or power supply, the flow will shut off completely.

PRECISE CONTROLS

We've made showering even simpler. Turn on the water by gently pressing the control dial, and watch the controls flash white as the shower heats up. When the controls stop flashing and begin to glow, the water's just how you like it – so step in and enjoy.

Our single outlet processor controls one showerhead, with a simple handle to adjust the temperature. Alternatively, the single outlet processor can be combined with our bath filler, allowing you to use the same precise controls to fill your bathtub.

The dual outlet processor controls two showerheads. Press the lower handle once to divert from the main outlet to the second showerhead, and a second time to run both at once.

The dual outlet bath / shower processor is used for a combined bath and shower. When you turn it on, the water will automatically flow from the bath outlet – just press once to divert to the showerhead.

Enhance your showering experience even further with the optional remote control. Used to switch the shower on and off – and divert between showerheads, if you have a dual outlet processor – the remote can be installed anywhere within 10m of the shower for your ultimate convenience.



DIGITAL FEATURES

The premium features of the Crosswater digital shower make it simpler, more innovative, and safer than conventional showers.

Learn more about these features, and how our digital shower works, over the following pages.



KEY FEATURES

PRECISE TEMPERATURE

Find the perfect temperature with precise and sophisticated controls. A built-in thermistor checks every 10th of a second to ensure the water stays as close as possible to the set temperature.

COOL-TOUCH METAL CONTROLS

Shower controls are kept completely separate from the water in the valve, which means they always stay cool and safe to touch.

COLOUR-CHANGING CONTROLS

When you switch on the shower the controls flash white as the water heats up to the set temperature. If you adjust the temperature, the LEDs flash red to let you know when the water is warming up and blue when it's cooling down. As soon as the desired temperature is reached, the controls stop flashing and glow white.

EASY DIVERT

Divert the flow quickly and easily between outlets with just a few touches. Press the lower control once to divert from the main showerhead to the second, and again to run both at once. In a shower bath, one touch switches from bath filler to the showerhead.

INSTALLATION

Save time and money. Push-fit isolation valves and a standard electrical plug fitting, as well as easy to set up cable connections, make the shower extremely simple to install.

CLEANING MODE

Activate to clean the controls without accidentally turning on your shower. Simply press and hold the power button to enable cleaning mode, which lasts for 1 minute.



OPTIONAL REMOTE

Fit an additional remote control anywhere outside of the shower and within 10m of the digital processor. The remote can be used to turn the shower or bath fill on and off, or to divert between showerheads.

CONSISTENT TEMPERATURE

The advanced thermostatic control automatically keeps the water at the set temperature - even if someone turns on a tap.

AUTOMATIC SHUT OFF

If your water or power supply fails, the shower will turn off completely - keeping you and your family safe.

QUIET PUMP

Get high pressure showering with less noise; the integrated pump on our low-pressure models features an extra quiet brushless motor.

FLEXIBLE OPTIONS

Choose from options for single showerheads, dual showerheads, and dual bath and shower flow.

TEMPERATURE OVERRIDE

Each digital processor has a pre-set maximum temperature of 41°C, and as bath temperatures are usually higher, the bath flow of the dual outlet shower bath is pre-set at 44°C. Both can be overridden and adjusted to 46°C.



TECHNOLOGY

At the core of our digital shower is the innovative digital processor, which contains sophisticated technology that controls and monitors the temperature, flow, and safety.

BRUSHLESS PUMP

Our low-pressure digital shower has a built-in pump that boosts the water pressure to 1.5 bar. It uses a brushless motor, which is much quieter and more efficient than conventional brushed motors.

TEMPERATURE THERMISTOR

The built-in thermistor checks the temperature of incoming water every 10th of a second, ensuring it's kept as close as possible to the set temperature.

FLÜHS CERAMIC CARTRIDGE

The highly reliable Flühs ceramic cartridge lies at the heart of the processor. It's controlled by a stepper motor, and automatically mixes the hot and cold water.

PUSH-FIT ELECTRICS

Simple, push-fit twist and lock electrical cables ensure there is no need to go inside the digital processor to set up the shower.

SOLENOID VALVES

If the cold water supply stops or there's a power failure, the solenoid valves will shut off the flow instantly. Two valves allow both outlets to be safely used at once, offering total peace of mind.

PUSH-FIT ISOLATION VALVES

The hot and cold water isolation valves allow you to isolate your water supply without having to switch it off at the mains.

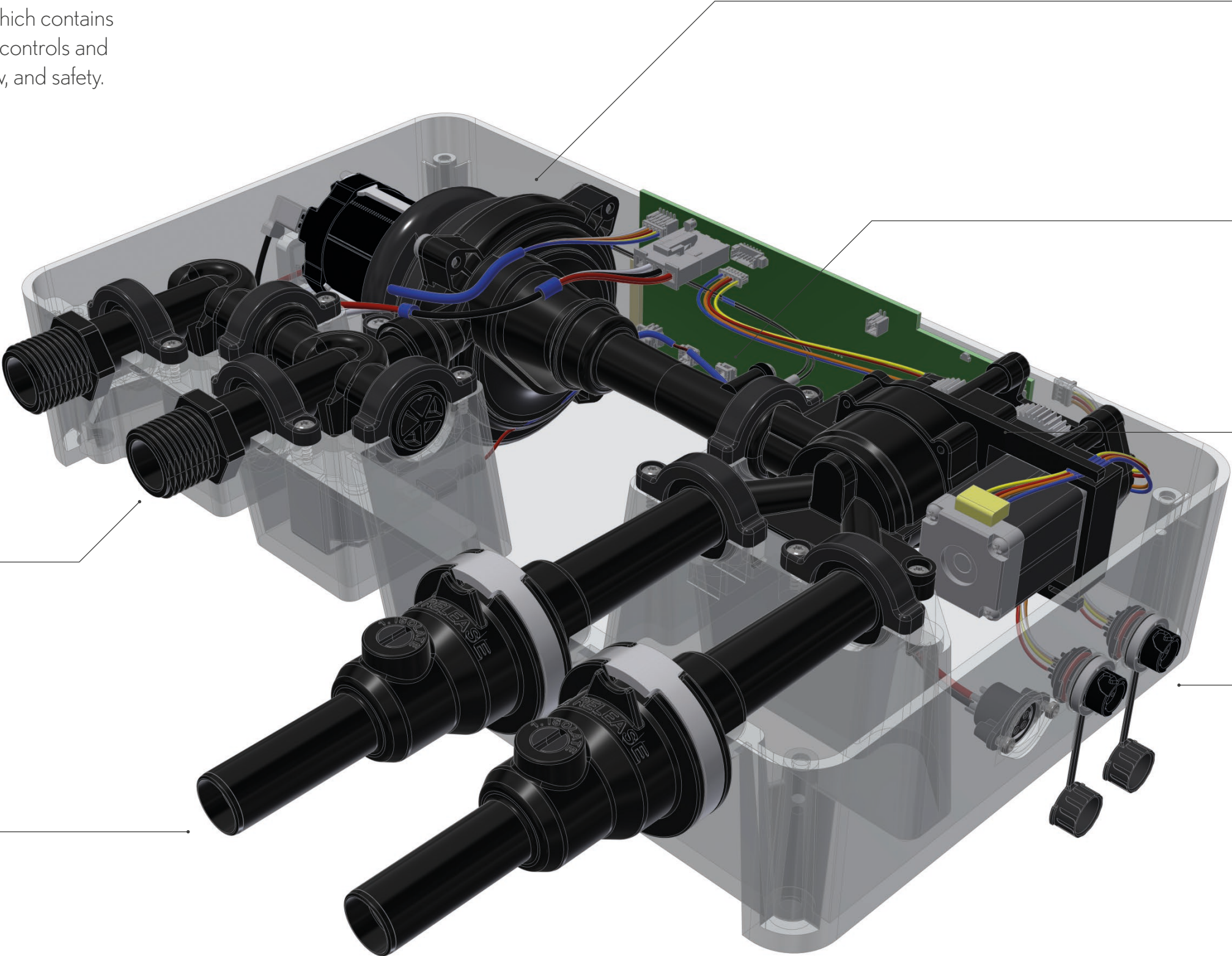



CHOOSING YOUR SHOWER

Over the following pages you'll find all the information you need to choose your digital shower.

Start by browsing our product collection on pages 18 to 23. Our simple, stylish range has been designed to suit any bathroom, and all of our digital showers are compatible with the optional one-touch remote control. Choose from a selection of control options and trim styles for either high or low-pressure systems.

Next, take a look at our digital packs on pages 24 to 27; we've picked out a selection of shower kits that match perfectly with our digital product to make things easier. If you'd like to select your own kit, there are countless single and multi-spray options to choose from in a huge selection of styles, and you can find the full collection in the Crosswater brochure and on the website.

Finally, if you're unsure about the type of water system in your home turn to page 31. Our simple diagrams will show you whether your system is high or low-pressure and help you understand which product is right for you.

KAI RANGE	18
BELGRAVIA RANGE	20
DIGITAL PACKS	24
ACCESSORIES & SHOWER KITS	28

Clean and understated, Kai is perfect for contemporary bathrooms. Match it with any of our modern shower kits to complete your shower.

RANGE AT A GLANCE	
REMOTE CONTROL	
SINGLE OUTLET	High or Low Pressure (Pumped)
DUAL OUTLET	Shower / Shower - High or Low Pressure (Pumped)
DUAL OUTLET	Bath / Shower - High or Low Pressure (Pumped)



KAI REMOTE
Finish: Chrome

Kai Trim Kit Remote Digital Processor
Product Code: DGXKLREM
£169.00 (inc. VAT)



KAI SINGLE OUTLET
Finish: Chrome

Kai Trim Kit Single Outlet Digital Processor High Pressure
Product Code: SOLOKLHP
£560.00 (inc. VAT)

Kai Trim Kit Single Outlet Digital Processor Low Pressure (Pumped)
Product Code: SOLOKLLP
£710.00 (inc. VAT)



KAI DUAL OUTLET (SHOWER / SHOWER)
Finish: Chrome

Kai Trim Kit Dual Outlet (Shower / Shower) Digital Processor High Pressure
Product Code: DUOKLHP
£700.00 (inc. VAT)

Kai Trim Kit Dual Outlet (Shower / Shower) Digital Processor Low Pressure (Pumped)
Product Code: DUOKLLP
£807.00 (inc. VAT)



KAI DUAL OUTLET (BATH / SHOWER)
Finish: Chrome

Kai Trim Kit Dual Outlet (Bath / Shower) Digital Processor High Pressure
Product Code: DUOBSKLHP
£700.00 (inc. VAT)

Kai Trim Kit Dual Outlet (Bath / Shower) Digital Processor Low Pressure (Pumped)
Product Code: DUOBSKLLP
£807.00 (inc. VAT)

BELGRAVIA CROSSHEAD

Complement the subtle nautical feel of Belgravia Crosshead handles with one of our traditional shower kits.

RANGE AT A GLANCE

REMOTE CONTROL	
SINGLE OUTLET	High or Low Pressure (Pumped)
DUAL OUTLET	Shower / Shower - High or Low Pressure (Pumped)
DUAL OUTLET	Bath / Shower - High or Low Pressure (Pumped)



BELGRAVIA CROSSHEAD



BELGRAVIA CROSSHEAD DUAL OUTLET (SHOWER / SHOWER)

Finish: Chrome

Belgravia Trim Kit Dual Outlet (Shower / Shower) – Crosshead Digital Processor High Pressure
Product Code: DUOBLHP
£739.00 (inc. VAT)

Belgravia Trim Kit Dual Outlet (Shower / Shower) – Crosshead Digital Processor Low Pressure (Pumped)
Product Code: DUOBLLP
£846.00 (inc. VAT)

BELGRAVIA CROSSHEAD DUAL OUTLET (BATH / SHOWER)

Finish: Chrome

Belgravia Trim Kit Dual Outlet (Bath / Shower) – Crosshead Digital Processor High Pressure
Product Code: DUOBSLHP
£739.00 (inc. VAT)

Belgravia Trim Kit Dual Outlet (Bath / Shower) – Crosshead Digital Processor Low Pressure (Pumped)
Product Code: DUOBSLLP
£846.00 (inc. VAT)



BELGRAVIA CROSSHEAD SINGLE OUTLET

Finish: Chrome

Belgravia Trim Kit Single Outlet – Crosshead Digital Processor High Pressure
Product Code: SOLOBLHP
£619.00 (inc. VAT)

Belgravia Trim Kit Single Outlet – Crosshead Digital Processor Low Pressure (Pumped)
Product Code: SOLOBLLP
£769.00 (inc. VAT)



BELGRAVIA REMOTE

Finish: Chrome

Belgravia Trim Kit Remote Digital Processor
Product Code: DGXBLREM
£189.00 (inc. VAT)

BELGRAVIA LEVER

The ceramic-finished Belgravia Lever adds a touch of luxury to any bathroom. Complete the look with a Crosswater traditional shower kit.

RANGE AT A GLANCE

REMOTE CONTROL	
SINGLE OUTLET	High or Low Pressure (Pumped)
DUAL OUTLET	Shower / Shower - High or Low Pressure (Pumped)
DUAL OUTLET	Bath / Shower - High or Low Pressure (Pumped)



BELGRAVIA LEVER



BELGRAVIA LEVER DUAL OUTLET (SHOWER / SHOWER)

Finish: Chrome

Belgravia Trim Kit Dual Outlet (Shower / Shower) – Lever Digital Processor High Pressure
Product Code: DUOBLHP_LV
£739.00 (inc. VAT)

Belgravia Trim Kit Dual Outlet (Shower / Shower) – Lever Digital Processor Low Pressure (Pumped)
Product Code: DUOBLLP_LV
£846.00 (inc. VAT)

BELGRAVIA LEVER DUAL OUTLET (BATH / SHOWER)

Finish: Chrome

Belgravia Trim Kit Dual Outlet (Bath / Shower) – Lever Digital Processor High Pressure
Product Code: DUOBSLHP_LV
£739.00 (inc. VAT)

Belgravia Trim Kit Dual Outlet (Bath / Shower) – Lever Digital Processor Low Pressure (Pumped)
Product Code: DUOBSLLP_LV
£846.00 (inc. VAT)



BELGRAVIA LEVER SINGLE OUTLET

Finish: Chrome

Belgravia Trim Kit Single Outlet – Lever Digital Processor High Pressure
Product Code: SOLOBLHP_LV
£619.00 (inc. VAT)

Belgravia Trim Kit Single Outlet – Lever Digital Processor Low Pressure (Pumped)
Product Code: SOLOBLLP_LV
£769.00 (inc. VAT)



BELGRAVIA REMOTE

Finish: Chrome

Belgravia Trim Kit Remote Digital Processor
Product Code: DGXBLREM
£189.00 (inc. VAT)

DIGITAL PACKS

Complete your bathroom with one of our digital packs. We've paired our digital processors with a collection of matching kits to make the whole thing easier – and to save you money, too. Browse our selection to choose your pack.



KAI PACK 01

Digital Processor – Single Outlet	
Kai Trim Kit	
Central Fixed Head	200mm
Shower Arm	330mm

High Pressure	
CODE: DGX001HP	£699.00 (inc. VAT)
Low Pressure (Pumped)	
CODE: DGX001LP	£849.00 (inc. VAT)

Minimum pressure required for high-pressure installation 0.5 bar. Minimum pressure required for low-pressure pumped installation 01 bar.



KAI PACK 02

Digital Processor – Single Outlet	
Kai Trim Kit – Single Outlet	
Svelte Shower Kit	

High Pressure	
CODE: DGX002HP	£729.00 (inc. VAT)
Low Pressure (Pumped)	
CODE: DGX002LP	£879.00 (inc. VAT)

Minimum pressure required for high-pressure installation 0.5 bar. Minimum pressure required for low-pressure pumped installation 01 bar.



KAI PACK 03

Digital Processor – Single Outlet	
Kai Trim Kit – Single Outlet	
Central Shower Kit with Wall Elbow	

High Pressure	
CODE: DGX003HP	£699.00 (inc. VAT)
Low Pressure (Pumped)	
CODE: DGX003LP	£849.00 (inc. VAT)

Minimum pressure required for high-pressure installation 0.5 bar. Minimum pressure required for low-pressure pumped installation 01 bar.



KAI PACK 04

Digital Processor – Dual Outlet (Shower/Shower)	
Kai Trim Kit – Dual Outlet (Shower/Shower)	
Central Fixed Head	200mm
Shower Arm	330mm
Svelte Shower Kit	

High Pressure	
CODE: DGX004HP	£999.00 (inc. VAT)
Low Pressure (Pumped)	
CODE: DGX004LP	£1119.00 (inc. VAT)

Minimum pressure required for high-pressure installation 0.5 bar. Minimum pressure required for low-pressure pumped installation 01 bar.



KAI PACK 05

Digital Processor - Dual Outlet (Shower/Shower)	
Kai Trim Kit - Dual Outlet (Shower/Shower)	
Central Fixed Head	200mm
Shower Arm	330mm
Central Shower Kit with Wall Elbow	

High Pressure	
CODE: DGX005HP	£979.00 (inc. VAT)
Low Pressure (Pumped)	
CODE: DGX005LP	£1089.00 (inc. VAT)

Minimum pressure required for high-pressure installation 0.5 bar. Minimum pressure required for low-pressure pumped installation 0.1 bar.



KAI PACK 06

Digital Processor - Dual Outlet (Shower/Shower)	
Kai Trim Kit - Dual Outlet (Shower/Shower)	
Handspray and Holder	
Central Fixed Head	200mm
Shower Arm	330mm

High Pressure	
CODE: DGX006HP	£979.00 (inc. VAT)
Low Pressure (Pumped)	
CODE: DGX006LP	£1089.00 (inc. VAT)

Minimum pressure required for high-pressure installation 0.5 bar. Minimum pressure required for low-pressure pumped installation 0.1 bar.



KAI PACK 07

Digital Processor - Dual Outlet (Bath/Shower)	
Kai Trim Kit - Dual Outlet (Bath/Shower)	
Central Fixed Head	200mm
Shower Arm	330mm
Bath Filler with Click Clack Waste	

High Pressure	
CODE: DGX007HP	£979.00 (inc. VAT)
Low Pressure (Pumped)	
CODE: DGX007LP	£1089.00 (inc. VAT)

Minimum pressure required for high-pressure installation 0.5 bar. Minimum pressure required for low-pressure pumped installation 0.1 bar.



KAI PACK 08

Digital Processor - Dual Outlet (Bath/Shower)	
Kai Trim Kit - Dual Outlet (Bath/Shower)	
Svelte Shower Kit	
Bath Filler with Click Clack Waste	

High Pressure	
CODE: DGX008HP	£999.00 (inc. VAT)
Low Pressure (Pumped)	
CODE: DGX008LP	£1119.00 (inc. VAT)

Minimum pressure required for high-pressure installation 0.5 bar. Minimum pressure required for low-pressure pumped installation 0.1 bar.



KAI PACK 09

Digital Processor - Dual Outlet (Bath/Shower)	
Kai Trim Kit - Dual Outlet (Bath/Shower)	
Central Shower Kit with Wall Elbow	
Bath Filler with Click Clack Waste	

High Pressure	
CODE: DGX009HP	£979.00 (inc. VAT)
Low Pressure (Pumped)	
CODE: DGX009LP	£1089.00 (inc. VAT)

Minimum pressure required for high-pressure installation 0.5 bar. Minimum pressure required for low-pressure pumped installation 0.1 bar.



KAI PACK 10

Digital Processor - Dual Outlet (Bath/Shower)	
Kai Trim Kit - Dual Outlet (Bath/Shower)	
Handspray and Holder	
Bath Filler with Click Clack Waste	

High Pressure	
CODE: DGX010HP	£979.00 (inc. VAT)
Low Pressure (Pumped)	
CODE: DGX010LP	£1089.00 (inc. VAT)

Minimum pressure required for high-pressure installation 0.5 bar. Minimum pressure required for low-pressure pumped installation 0.1 bar.

ACCESSORIES AND SHOWER KITS

Outside of our digital packs there are countless single and multi-spray kit options to choose from, as well as additional accessories – such as the bath filler – to complete your shower.

We’ve listed the featured accessories below, and you can find the full collection of modern and traditional ranges in the Crosswater brochures or online at crosswater.co.uk



CENTRAL FIXED HEAD

Finish: Chrome

Central Fixed Head CODE: FH200C+	£119.00 (inc. VAT)
Shower Arm CODE: FH684C	£75.00 (inc. VAT)
Ceiling Arm CODE: FH685C	£99.00 (inc. VAT)

BELGRAVIA FIXED HEAD

Finish: Chrome

150mm CODE: FH06C	£119.00 (inc. VAT)
200mm CODE: FH08C	£159.00 (inc. VAT)
300mm CODE: FH12C	£269.00 (inc. VAT)
Shower Arm CODE: BL684C	£85.00 (inc. VAT)
Ceiling Arm CODE: FH685C	£99.00 (inc. VAT)

BELGRAVIA EASY CLEAN SHOWER HEAD

Finish: Chrome

200mm CODE: FH08C_EC+	£189.00 (inc. VAT)
Shower Arm CODE: BL684C	£85.00 (inc. VAT)
Ceiling Arm CODE: FH685C	£99.00 (inc. VAT)



BELGRAVIA HANDSPRAY AND HOLDER

Finish: Chrome

CODE: BL964C	£159.00 (inc. VAT)
--------------	---------------------------



HANDSPRAY AND HOLDER

Finish: Chrome

CODE: SK963C	£139.00 (inc. VAT)
--------------	---------------------------



CENTRAL SHOWER KIT

Finish: Chrome

Central Shower Kit CODE: SK984C	£149.00 (inc. VAT)
Wall Elbow CODE: WL953C	£29.00 (inc. VAT)



SVELTE SHOWER KIT

Finish: Chrome

CODE: SVELTEPACKAGE 1	£185.00 (inc. VAT)
-----------------------	---------------------------



BATH FILLER WITH CLICK CLACK WASTE

Finish: Chrome

CODE: BFW0168C	£199.00 (inc. VAT)
----------------	---------------------------

DIMENSIONS

There may be times when you or your plumber needs to know the exact size of the digital processor, so we've added dimensions for each model below.

SINGLE OUTLET DIGITAL PROCESSOR FOR HIGH-PRESSURE INSTALLATIONS

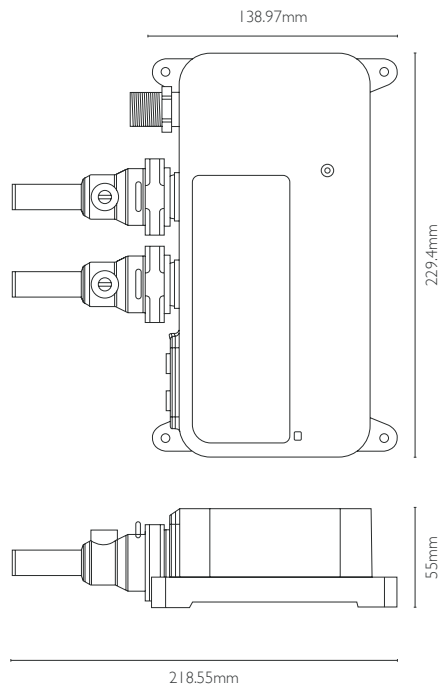

SINGLE OUTLET PUMPED DIGITAL PROCESSOR FOR LOW-PRESSURE INSTALLATIONS

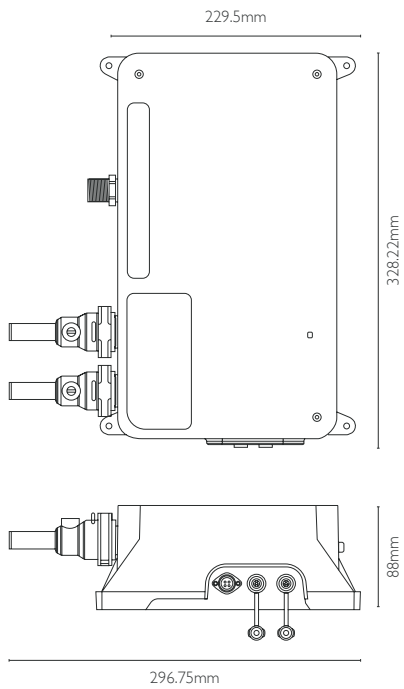

DUAL OUTLET DIGITAL PROCESSOR FOR HIGH-PRESSURE INSTALLATIONS*

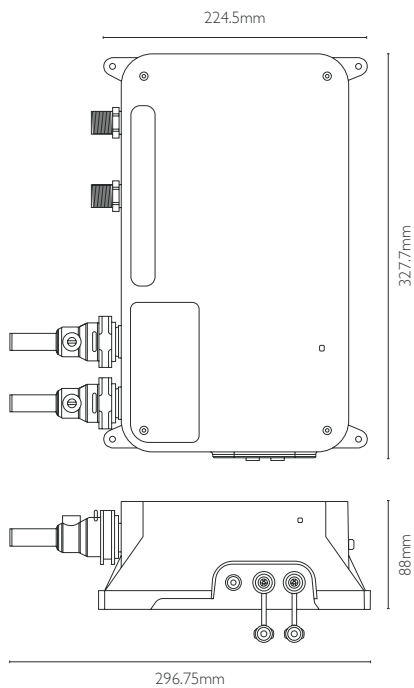

DUAL OUTLET PUMPED DIGITAL PROCESSOR FOR LOW-PRESSURE INSTALLATIONS*

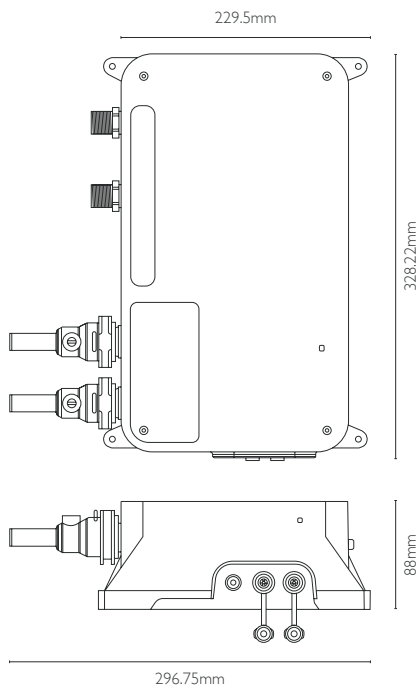

WATER SYSTEMS

The diagrams below will help you to understand which water system you have in your home. If you have a mains high-pressure, combination boiler, or pump-assisted system, choose one of our high-pressure digital showers.

If you have a gravity-fed system, you'll need a low-pressure option with an integrated pump. Our pumps have extra quiet brushless motors, so you won't have to worry about too much noise.

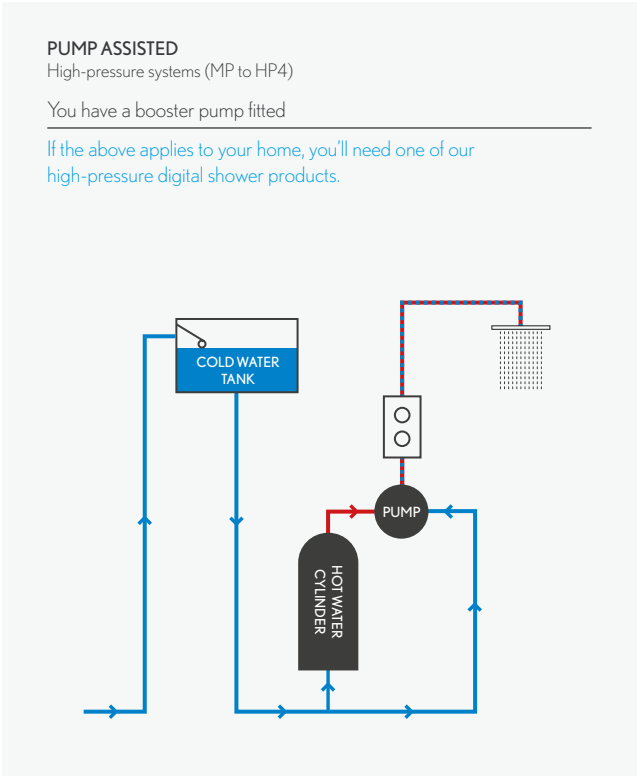
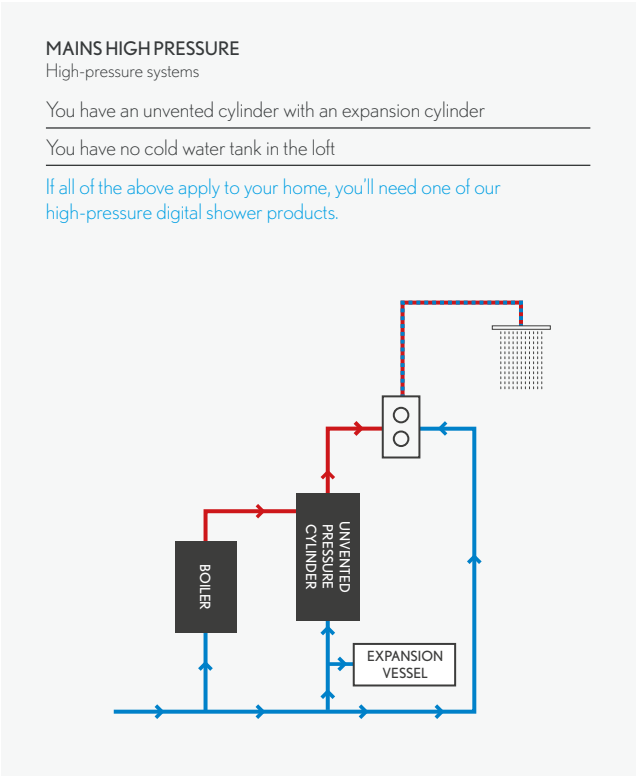
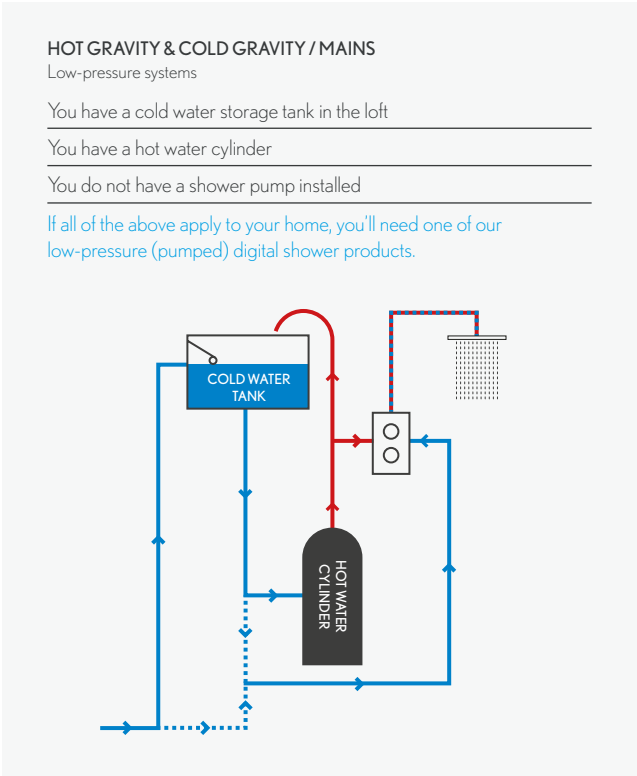
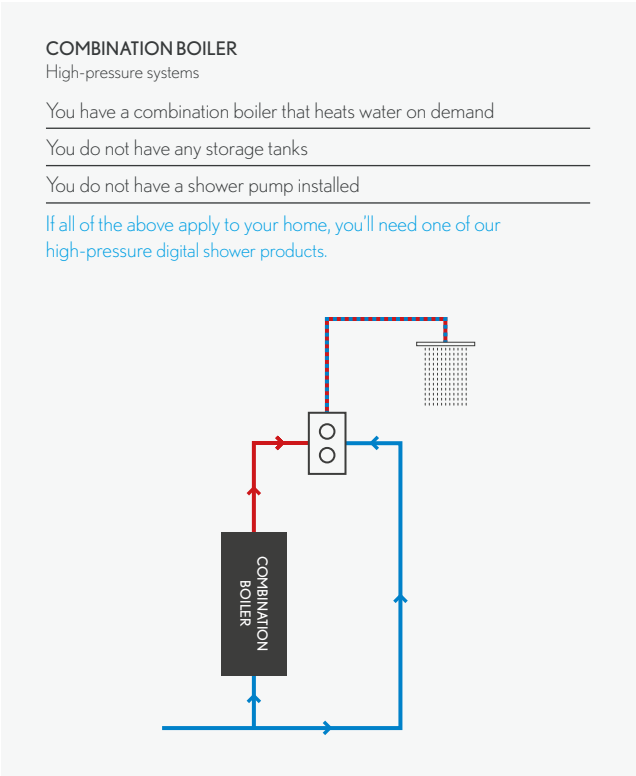

INSTALLATION

The digital processor can be installed in a few different locations depending on the layout of your bathroom and your own preferences. Whatever you choose, it will be discreetly hidden out of sight. The processor can be fitted up to 10 metres away from the control unit.

LOFT INSTALLATION

This layout is ideal if you have loft space directly above your bathroom.

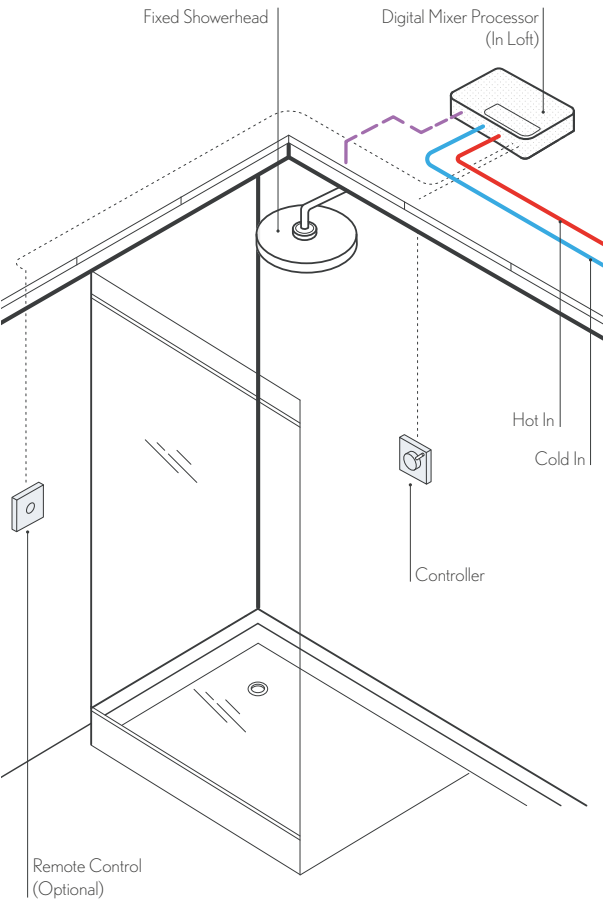

- Pipework Out (Mixed Water)
- Pipework In (Cold)
- Pipework In (Hot)
- Controller Cable

UNDER-BATH INSTALLATION

If you have an over-bath shower, there may be space to hide the processor behind the bath panel.

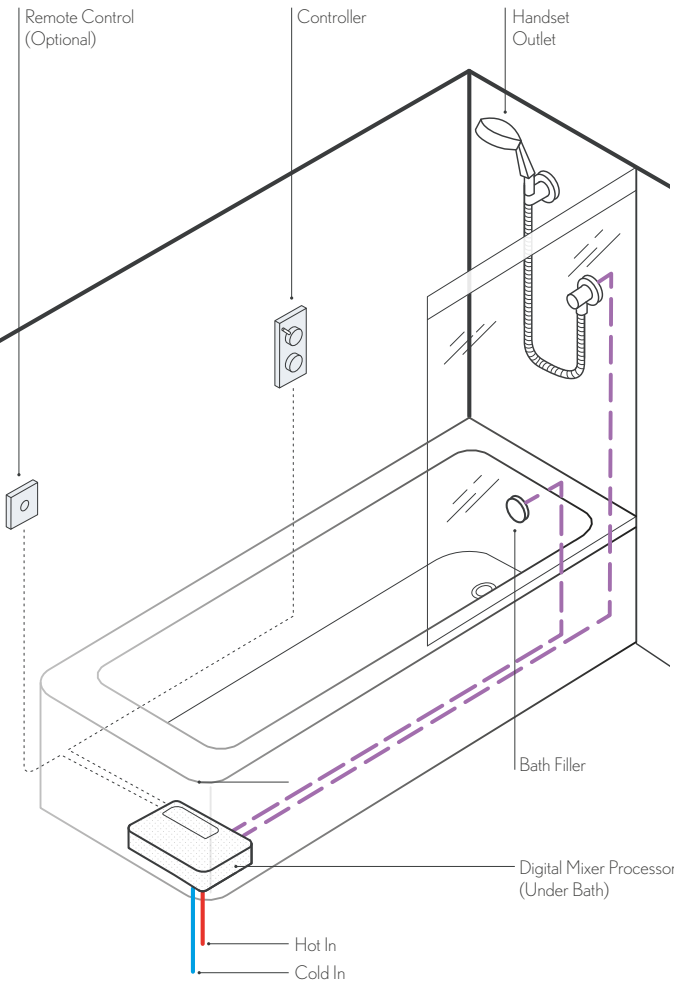

- Pipework Out (Mixed Water)
- Pipework In (Cold)
- Pipework In (Hot)
- Controller Cable

CUPBOARD INSTALLATION

The digital processor and power cables can be concealed in an adjacent cupboard.

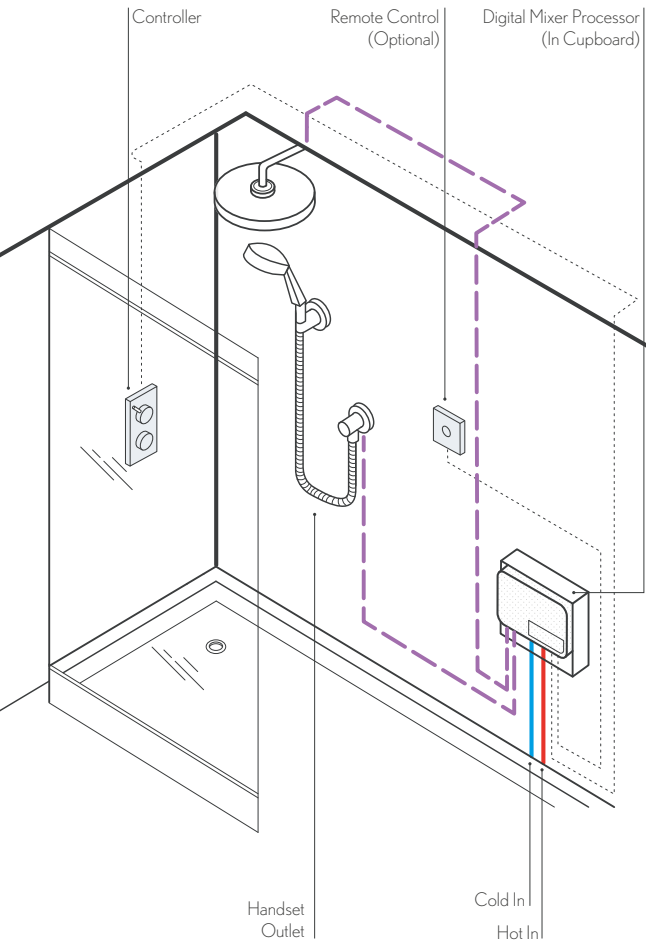

- Pipework Out (Mixed Water)
- Pipework In (Cold)
- Pipework In (Hot)
- Controller Cable



5 YEAR GUARANTEE

All our digital products come with a 5-year guarantee. This guarantee, however, does not cover any damage during fitting, misuse or inappropriate cleaning. Additionally, shower hoses are only covered for one year. If you'd like to know more about the terms of our guarantee, visit the website.

PRICES

This price list supersedes all previous publications with goods being invoiced at prices ruling on date of despatch. Prices are subject to alteration without notice and include VAT.

DELIVERY

Orders in excess of £50.00 nett invoice value will not be subject to carriage charge and will be delivered within two working days from receipt of order. Orders below £50.00 will be subject to a fixed charge of £5.00.

We will endeavour to deliver all orders on time and in full however we shall be under no liability for any delay or failure to deliver products. Any claim for non-delivery must be reported to the company within 14 working days from the date of delivery, such claims will not be accepted for deliveries to a third-party delivery address.

RETURNED GOODS

Requests to return goods must be made in writing to Returns.Department@crosswater.co.uk and include the product details, purchase order, order number and reason for return. All requests must be received within 21 days of the delivery date, must be in perfect condition and in the original packaging, and all will be subject to 25% re-stocking charge. Requests to collect from a residential premises will be subject to a £30 fixed charge. Special orders are nonreturnable.

CLEANING & MAINTENANCE

All Crosswater products should be cleaned with warm soapy water only and polished with a clean, soft, dry cloth. When installing wall mounted products, Crosswater strongly recommend making provisions for an in-wall access point, particularly when tiling, for maintenance purposes.

PRODUCT COMPATIBILITY

All brassware products featured in the brochure are from Crosswater. Whilst the majority of Crosswater products are compatible, care should be taken on product selection prior to ordering to avoid installation issues.

RETENTION OF TITLE

Ownership of goods shall remain in the Company until full payment has been received for all goods comprised in this contract. If any goods are re-sold before payment is made the Company's right of ownership shall be transferred to the proceeds of sale or to the claim for such proceeds.

LIABILITY

All quotations are given and goods sold subject to the conditions that the seller's liability is limited to goods proven to have been defective in material or workmanship when they left the sellers' works. No claim will be accepted where goods have not been used for the purpose for which they were intended, not fitted correctly, not maintained to the seller's recommended standards or have been abused or misused.

ERRORS AND OMISSIONS

In the interest of continuing design and development and product improvement, Crosswater reserve the right to change colour, designs and product specifications without prior notice.

ACCREDITATION AND TESTING

All Crosswater digital showers are rigorously tested to the highest standards. Our digital products comply with electrical safety standards BSEN60335-1: 2002 and BSEN60335-2-41: 2003, and thermostatic performance BSEN1111 and BSEN1287, and have been fully approved by WRAS and conform to TMV2 ensuring we bring you the best and safest products we can.



Discover Crosswater's stunning bathroom solutions in our range of brochures, available online and in stores.



Crosswater is a unique range of designer brassware solutions.
www.crosswater.co.uk



Bauhaus is a stylish collection of basins, sanitaryware and a versatile range of bathroom furniture.
www.bauhaus-bathrooms.co.uk



Simpsons is a comprehensive range of shower enclosures and modular wetroom solutions.
www.simpsons-enclosures.co.uk



Crosswater Cucina is an outstanding collection of kitchen taps and sinks.
www.crosswater-cucina.co.uk

CONTACT US

Lake View House,
Rennie Drive,
Dartford,
Kent DA1 5FU

www.crosswaterdigital.co.uk

SALES

Telephone: 0845 873 8840
Email: sales@crosswater.co.uk

TECHNICAL SUPPORT

Telephone: 0345 241 1195
Email: digital@crosswater.co.uk

November 2016

crosswaterTM 